

# INTERNATIONAL CONFERENCE



The Second International Conference on  
Engineering and Technology Development

# 2<sup>nd</sup> ICETD 2013

27, 28, 29 August 2013, Bandar Lampung, Indonesia



**PROCEEDINGS**



In  
Cooperations  
With :



الجامعة الإسلامية العالمية  
INTERNATIONAL ISLAMIC UNIVERSITY MALAYSIA  
يؤيدون منقون الشارة القارة نظرا مالكم



Hosted by :

Faculty of Engineering and Faculty of Computer Science,  
Bandar Lampung University (UBL), Indonesia

# 2<sup>nd</sup> ICETD 2013

THE SECOND INTERNATIONAL CONFERENCE  
ON ENGINEERING AND TECHNOLOGY DEVELOPMENT

28 -30 January 2013  
Bandar Lampung University (UBL)  
Lampung, Indonesia

## PROCEEDINGS

Organized by:



Faculty of Computer Science and Faculty of Engineering  
Bandar Lampung University (UBL)  
Jl. Zainal Abidin Pagar Alam No.89 Labuhan Ratu, Bandar Lampung, Indonesia  
Phone: +62 721 36 666 25, Fax: +62 721 701 467  
website : [www.ubl.ac.id](http://www.ubl.ac.id)

## PREFACE

The Activities of the International Conference is in line and very appropriate with the vision and mission of Bandar Lampung University (UBL) to promote training and education as well as research in these areas.

On behalf of the Second International Conference on Engineering and Technology Development ( 2<sup>nd</sup> ICETD 2013) organizing committee, we are very pleased with the very good response especially from the keynote speaker and from the participants. It is noteworthy to point out that about 80 technical papers were received for this conference.

The participants of the conference come from many well known universities, among others : University Kebangsaan Malaysia – Malaysia, APTIKOM – Indonesia, Institut Teknologi Sepuluh Nopember – Indonesia, Surya Institute – Indonesia, International Islamic University – Malaysia, STMIK Mitra Lampung – Lampung, Bandung Institut of Technology – Bandung, Lecture of The Malahayati University, B2TP – BPPT Researcher – Lampung, Starch Technology Center – Lampung, Universitas Islam Indonesia – Indonesia, Politeknik Negeri Malang – Malang, University of Kitakyushu – Japan, Gadjah Mada University – Indonesia, Universitas Malahayati – Lampung, Lampung University – Lampung, Starch Technology Center – Lampung, Universitas Riau – Riau, Hasanuddin University – Indonesia, Diponegoro University – Indonesia, King Abdulaziz University – Saudi Arabia, Parahyangan Catholic University – Indonesia , National Taiwan University – Taiwan, Surakarta Christian University – Indonesia, Sugijapranata Catholic University – Indonesia, Semarang University – Indonesia, University of Brawijaya – Indonesia, PPKIA Tarakanita Rahmawati – Indonesia, Kyushu University, Fukuoka – Japan, Science and Technology Beijing – China, Institut Teknologi Sepuluh Nopember – Surabaya, Researcher of Starch Technology Center, Universitas Muhammadiyah Metro – Metro, National University of Malaysia – Malaysia.

I would like to express my deepest gratitude to the International Advisory Board members, sponsor and also to all keynote speakers and all participants. I am also grateful to all organizing committee and all of the reviewers who contribute to the high standard of the conference. Also I would like to express my deepest gratitude to the Rector of Bandar Lampung University (UBL) who give us endless support to these activities, so that the conference can be administrated on time

Bandar Lampung, 29 August 2013-08-26

Mustofa Usman, Ph.D  
2<sup>nd</sup> ICETD Chairman

# **PROCEEDINGS**

## **2<sup>nd</sup> ICETD 2013**

The Second International Conference  
On Engineering And Technology Development

**28 -30 January 2013**

### **INTERNATIONAL ADVISORY BOARD**

Y. M Barusman, Indonesia  
Ahmad F. Ismail, Malaysia  
Mustofa Usman, Indonesia  
Moses L. Singgih, Indonesia  
Andreas Dress, Germany  
Faiz A.M Elfaki, Malaysia  
Warsono, Indonesia  
Raihan Othman, Malaysia  
Zeng Bing Zen, China  
Tjin Swee Chuan, Singapore  
Khomsahrial R, Indonesia  
Rony Purba, Indonesia  
Alex Tribuana S, Indonesia  
Hon Wei Leong, Singapore  
Imad Khamis, USA  
Rozlan Alias, Malaysia  
Rudi Irawan, Indonesia  
Gusri Ibrahim, Indonesia  
Jamal I Daoud, Malaysia  
Riza Muhida, Indonesia  
Heri Riyanto, Indonesia  
Agus Wahyudi, Indonesia  
Lilies Widojoko, Indonesia

# **PROCEEDINGS**

## **2<sup>nd</sup> ICETD 2013**

The Second International Conference  
On Engineering And Technology Development

**28 -30 January 2013**

### **STEERING COMMITTEE**

#### **Executive Advisors**

Dr. M. Yusuf S. Barusman  
Andala R. P. Barusman, MA.Ec

#### **Chairman**

Mustofa Usman, Ph.D

#### **Co-Chairman**

Dr. Ir. Hery Riyanto, MT  
Ahmad Cucus, S.Kom., M.Kom

#### **Secretary**

Marzuki, S.Kom., M.Kom  
Maria Shusanti Febrianti, S.Kom., M.Kom

#### **Technical Committee**

Indyah Kumoro, ST. IAI  
Ardiansyah, ST., MT  
Sofiah Islamiah, ST. MT  
Taqwan Thamrin, ST., MSc  
Dina Ika Wahyuningsih, S.Kom  
Agus Sukoco, M.Kom  
Hj. Susilowati, ST. MT  
Haris Murwadi, ST, MT  
Robby Yuli Endra, S.Kom., M.Kom  
Fenty Ariani, S.Kom., M.Kom

#### **Treasure**

Samsul Bahri, SE  
Dian Agustina, SE

# **PROCEEDINGS**

## **2<sup>nd</sup> ICETD 2013**

The Second International Conference  
On Engineering And Technology Development

**28 -30 January 2013**

### **ORGANIZING COMMITTEE**

#### **Chair Person**

Dr. Ir. Hery Riyanto, MT

#### **Vice Chair Person**

Yuthsi Aprilinda, S.Kom., M.Kom

#### **Treasure**

Dian Agustina, S.E

#### **Secretary**

Aprizal, ST. MT

Ir. Tjejeng Sofyan, MM

Ir. Muhammad Zein, MT

Ir. Bambang Pratowo, MT

#### **Special Events**

Ir. Juniardi, MT

Ir. Indra Surya, MT

Ir. Sugito, MT

DR. Baginda Simaibang, M.Ed

Berry Salatar, S.Pd

Yanuar Dwi Prasetyo, S.Pd.I., M.A

#### **Receptionist**

Ir. Najamudin, MT

Kunarto, ST. MT

IB. Ilham Malik, ST. MT

Ir.A Ikhsan Karim, MT

Ir. Asikin, MT

Usman Rizal, ST., M.MSi

#### **Transportation and Acomodation**

Irawati, SE

Desi Puspita Sari, S.E

Tanto Lailam, S.H

Ilyas Sadad, S.T., M.T

**Publication and Documentation**

Ir. Indriati Agustina Gultom, M.M

Noning Verawati, S.Sos

Hesti, S.H

Rifandi Ritonga, SH

Violita, S.I.Kom

**Cosumption**

Dra. Yulfriwini, M.T

Wiwin Susanty, S.Kom., M.Kom

Fenty Ariani, S.Kom., M.Kom

Reni Nursyanti, S.Kom., M.Kom

Erlangga, S.Kom

Arnes Yuli Vandika, S.Kom

**Facility and Decoration**

Siti Rahma Wati,SE

Dina Ika Wahyuningsih, S.Kom

Zainal Abidin, SE

Ahyar Saleh, SE

Eko Suhardiyanto

Wagino

Sugimin

## Table Of Content

Organizing Committee .....	i
Table Of Content.....	v
Keynote Speaker	
1. Recent Advances in Biofuel Cell and Emerging Hybrid System <b>Abdul Aziz Ahmad and Raihan Othman</b> .....	1
2. Waste Utilization Study Tailing Gold Mine in Way Linggo-Lampung, as Fine Aggregate Materials for Producing Mortar Materials based on concept of Green Technology <b>Lilies Widodojoko &amp; Susilawati</b> .....	8
3. Infrastructure Health Monitoring System (SHM) Development, a Necessity for Maintance and Investigation <b>Prof. Dr. Priyo Suprobo, Faimun, Arie Febry</b> .....	17
4. Four Phases Quality Function Deployment (Qfd) By Considering Kano Concept, Time And Manufacturing Cost <b>Prof. Dr. Moses L Singgih, Dyah L. Trenggonowati, Putu D. Karningsih</b> ....	22



Speaker

1. Comparative Analysis for The Multi Period Degree Minimum Spanning Tree Problem  
**Wamiliana, Amanto, and Mustofa Usman**..... 39
2. Choosing The Right Software In Supporting The Successful of Enterprise ERP Implementation  
**Yodhie Yuniarthe, Idris Asmuni**..... 44
3. Climate Adaptive Technology In Maintaining Vernacularism Of Urban Kampong Case study: Kampung Adat (Indiginous) Mahmud, Bandung District, West Java  
**Marcus Gartiwa**..... 50
4. The Prospect Of Diesohol In Facing Fossil Fuel Crissis  
**M.C. Tri Atmodjo**..... 63
5. The Potential Of Agriculture And Forestry Biomass Wastes As Source Of Bioenergy  
**Hardoyo**..... 66
6. The Importance of Education Facility as Sustainable Urban Generation Tool  
**Fritz Akhmad Nuzir, Haris Murwadi and Bart Julien Dewancker** ..... 71
7. The implementation of Secton Method for Solving Systems of Non Linear Equations  
**Nur Rokhman** ..... 80
8. Quality Control Analysis Into Decrease The Level Defects On Coffee Product  
**Heri Wibowo, Sulastri and Emy Khikmawati** ..... 85
9. Public Transpotion Crisis In Bandar Lampung  
**Ida Bagus Ilham Malik** ..... 89
10. Geospatial Analysis of Land Use Change in Way Kuripan Watershed, Bandar Lampung City  
**Candra Hakim Van Rafi'1., Dyah Indriana Kusumastuti2., Dwi Jokowinarno**..... 99
11. Material Utilization Technology Of Agriculture And Forestry Waste  
**Hardoyo**..... 105
12. The Supply Chain System Of Cassava On The Tapioca Industry  
**Hardoyo**..... 108
13. Glass Technology In Natural Light Glasses On Aperture Element In The Architecture World  
**Muhammad Rija & MT Pedia Aldy** ..... 113

14. An Eksperimental Permeable Asphalt Pavement Using Local Material Domato Stone On Quality Of Porous Asphalt <b>Firdaus Chairuddin, Wihardi Tjaronge, Muhammad Ramli, Johannes Patanduk</b> .....	117
15. Coordination Of Architectural Concepts And Construction Systems <b>Eddy Hermanto.</b> .....	129
16. Seismic Assessment of RC Building Using Pushover Analysis <b>Riza Ainul Hakim.</b> .....	136
17. Viscosity and Liquidity Index Relation for Elucidating Mudflow Behavior <b>Budijanto Widjaja and Shannon Hsien-Heng Lee.</b> .....	143
18. The Use of Pozzolanic Material for Improving Quality of Strontium Liquid Waste Cementation in Saline Environment during Nuclear Waste Immobilization Process <b>Muhammad Yusuf, HayuTyasUtami, Tri SulistiyoHariNugroho, SusetyoHarioPutero</b> .....	148
19. Geospatial Analysis Of Land Use And Land Cover Changes For Discharge At Way Kualagaruntang Watershed In Bandar Lampung <b>Fieni Yuniarti, Dyah Indriana K, Dwi Joko Winarno.</b> .....	153
20. Wifi Network Design For High Performance <b>Heru Nurwarsito, , KasyfulAmron,BektiWidyaningsih</b> .....	161
21. Studi on The Efficiency Using Nature Materials in The Structural Elements of Reinforced Concrete Beam <b>Yasser , Herman Parung , M. Wihardi Tjaronge, Rudy Djamaluddin.</b> .....	167
22. The Research Of Slow Release Nitrogen Fertilizer Applied In Sugarcane (Saccharum Officinarum) For Green Energy Bioethanol <b>M.C. Tri Atmodjo, Agus Eko T. Nurul Rusdi, Sigit Setiadi, and Rina.</b> .....	179
23. Energy Utilization Technology Of Agriculture And Forestry Waste <b>Hardoyo.</b> .....	185
24. Implementation Of Fuzzy Inference System With Tsukamoto Method For Study Programme Selection <b>Fenty Ariani and Robby Yuli Endra.</b> .....	189
25. The Analysis of Video Conference With ITU Standarization (International Telecommunication Union) That Joining in Inherent At Bandar Lampung University <b>Maria Shusanti F, Happy Reksa</b> .....	201

26. The E-internal audit iso 9001:2008 based on accreditation form assessment matrix in study program for effectiveness of monitoring accreditation  
**Marzuki, Maria Shusanti F.** ..... 207
27. The Developing Of e-Consultations For Effectiveness of Mentoring Academy  
**Ahmad Cucus, Endang K** ..... 214
28. The Evaluation of information system performance in higher education case study with EUCS model at bandar lampung university  
**Reni Nursyanti, Erlangga.** ..... 221
29. The Analysis Of History Collection System Based On AndroidSmartphone With Qr Code Using Qr CodeCase Study: Museum Lampung  
**Usman Rizal, Wiwin Susanty, Sutrisno.**..... 230
30. Application of Complaint Handling by Approach Model of ISO 10002 : 2004 to Increase Complaint Services  
**Agus Sukoco and Yuthsi Aprilinda.** ..... 235
31. Towards Indonesian Cloud Campus  
**Taqwan Thamrin, Iing Lukman, Dina Ika Wahyuningsih** ..... 252
32. Bridging Router to ADSL Modem for Stability Network Connection  
**Arnes Yuli Vandika and Ruri Koesliandana.**..... 257
33. The Effect of Use Styrofoam for Flexural Characteristics of Reinforced Concrete Beams  
**Yasser , Herman Parung, M. Wihardi Tjaronge, Rudy Djamaluddin** ..... 261
34. The Estimation Of Bioethanol Yield From Some Cassava Variety  
**M.C. Tri Atmodjo**..... 273
35. Effect of Superficial Velocity of Pressure Difference on The Separation of Oil And Water by Using The T-Pipe Junctionl  
**Kms. Ridhuan and Indarto.**..... 277
36. The use of CRM for Customer Management at Cellular Telecommunications Industry  
**Ayu Kartika Puspa.**..... 293
37. Indonesian Puslit (Centre Of IT Solution) Website Analysis Using Webqual For Measuring Website Quality  
**Maria Shusanti Febrianti and Nurhayati.** ..... 297
38. The E-internal audit iso 9001:2008 based on accreditation form assessment matrix in study program for effectiveness of monitoring accreditation  
**Marzuki, Maria Shusanti F.** ..... 307

39. Enhancing Quality Software Through CMMI-ISO 9001:2008 and ISO 9126 <b>Agus Sukoco</b> .....	320
40. Value Analysis Of Passenger Car Equivalent Motorcycle (Case Study Kartini Road Bandar Lampung) <b>Juniardi, Aflah Efendi</b> .....	337
41. Alternative Analysis Of Flood Control Downstream Of Way Sekampung River <b>Sugito, Maulana Febramsyah.</b> .....	347
42. Analysis Of Fitness Facilities And Effective Use Of Crossing Road <b>Juniardi, Edi Haryanto.</b> .....	353
43. Study On Regional Development Work Environment Panjang Port Lands In Support Bandar Lampung City As A Service And Trade <b>Ir. A. Karim Iksan, MT, Yohn Ferry.</b> .....	359
44. Analytical And Experimental Study Bamboo Beam Concrete <b>Hery Riyanto, Sugito, Juli</b> .....	370
45. Comparative Analysis Of Load Factor Method Static And Dynamic Method (Case Study Akdp Bus Route Rajabasa - Bakauheni) <b>A. Ikhsan Karim, MT., Ahmad Zulkily.</b> .....	378
46. Optimization Utilization Of Water Resources dam Batutegei Using Method Of Linear Program <b>Aprizal, Hery Fitriyansyah</b> .....	386
47. Characteristics Generation Traffic Patterns And Movement In Residential Area (Case Study Way Kandis Residential Bandar Lampung) <b>Fery Hendi Jaya, Juniardi,</b> .....	392
48. Use Study On Slight Beam Reinforced Concrete Floor Plate in Lieu Of Secondary Beam <b>Hery Riyanto, Sugito, Lilies Widodjoko, Sjamsu Iskandar</b> .....	399
49. Observation Of The Effect Of Static Magnetic Field 0.1 Mt On A-Amylase Activity In Legume Germination <b>Rochmah Agustrina, Tundjung T. Handayani, and Sumardi.</b> .....	405
50. Effectiveness Analysis Of Applications Netsupport School 10 Based Iso / Iec 9126-4 Metrics Effectiveness <b>Ahmad Cucus, Nelcy Novelia</b> .....	413
51. Comparative Performance Analysis Of Banking For Implementing Internet Banking <b>Reza Kurniawan</b> .....	418

## Seismic Assessment of RC Building Using Pushover Analysis

Riza Ainul Hakim<sup>#1</sup>

<sup>#</sup>Civil Department, King Abdulaziz University  
P.O Box 80200 Zip Code 21589 Jeddah-Kingdom of Saudi Arabia

<sup>1</sup>[ainul7@yahoo.com](mailto:ainul7@yahoo.com)

**Abstract:** *Current research works indicated that parts of Kingdom of Saudi Arabia have low to moderate seismic regions. For structural engineers, seismic load should be considered as important aspect that needs to be included in the building design. However Major part of buildings are designed for gravity loading only and poorly detailed to accommodate lateral loads. The purpose of this paper is to investigated gravity supporting building its resistance to expected seismic loading in different regions (Makkah, Jeddah, Gizan and Haql). In this paper, a test RC building that was designed for gravity loading only is investigated. This will be accomplished by performing the nonlinear static analysis (pushover analysis) according to ATC 40. Pushover analysis produces the pushover curves, capacity spectrum, plastic hinges and performance level of the building. This analysis gives better understanding seismic performance of buildings and also traces the progression of damage or failure. The building performance level is determined by intersection of demand and capacity curves and the hinge developed in the beams and the columns. The results show that the test building is found inadequate for Haql region and it still can be considered for Makkah, Jeddah and Gizan.*

**Keywords—** *seismic analysis; pushover; ATC 40; seismic zone; capacity spectrum*

### Introduction

The Kingdom of Saudi Arabia lies within low to moderate seismic region. Seismic load should be considered as important aspect that needs to be included in the building design. In the past decades, the inclusion of dynamic loads in the design of building in Saudi Arabia was very much limited to important huge structures. Recently, the development and adoption of a national code and the experienced seismic activity at several regions in the Kingdom necessitate the detailed consideration of seismic loads in the design of all buildings. Major part of building industry are designed for gravity loading only and poorly detailed to accommodate lateral loads. The existing buildings have to be provided by some rehabilitation to sustain the expected performance level. The capacity of the building should be evaluated before rehabilitation work [4].

It is generally believe that the conventional elastic design analysis

method cannot capture many important aspects that control the seismic performance of the building. The capacity of building to undergo inelastic deformations governs the structural behaviour of building during seismic ground motions. For that reason, the evaluation of building should be based the inelastic deformation demanded by seismic. On the other hand, linear elastic analysis does not provide information about real strength, ductility and energy dissipation [5].

Nonlinear dynamic analysis is principally correct approach. However, it is very complex and not practical for every design. It needs time history of ground motion data and detailed hysteretic behaviour of structural members which cannot be predicted. This analysis is appropriate for research and for design of important structures [11].

For estimating seismic demands for building, the structural engineering profession is now using the non-linear

static procedure, known as pushover analysis. It is a commonly used technique, which is finding prominence in standards and guidance material. The term static implies that a static method is applied to represent a dynamic phenomenon [6].

Pushover analysis is a series of incremental static analysis carried out to develop a capacity curve for the building. Figure 1 illustrates pushover analysis. This procedure needs the execution of a nonlinear static analysis of structure that allows monitoring progressive yielding of the structure. The building is subjected a lateral load. The load magnitude increase until the building reaches target displacement. This target displacement is determined to represent the top displacement when the building is subjected to design level ground excitation.

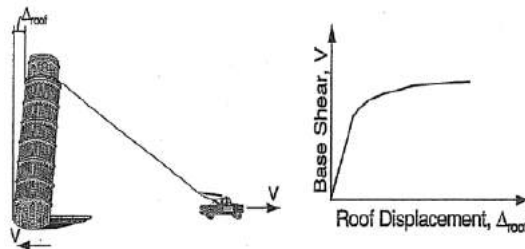

Fig. 1 Illustration of Pushover Analysis [ATC 40]

Pushover analysis produces pushover curve or capacity curve that presents relationship between base shear ( $V$ ) and roof displacement ( $\Delta$ ). The Pushover curve depends on strength and deformation capacities of the structure and describes how the structure behaves after the elastic limit.

Structural response to ground motion during earthquake cannot be accurately predicted due to the complexity of the structural properties and ground motion parameters. In pushover analysis, a set of lateral displacement is used directly as design condition. The displacement is an estimate of the maximum expected response of the structure during ground motion.

Once pushover analysis is defined, the performance level can be

determined using demand displacement. The performance verifies the structure is adequate the acceptable limits of performance level.

Recently, there are some codes such as ATC-40, FEMA 256, FEMA 440 adopted standards and guidance materials regarding the assessment of existing structures. Some programs are also developed for pushover analysis and are listed: SAP2000, ETABS, and DRAIN-2DX.

#### A. Capacity Spectrum

Building performance level can be determined by target displacement using capacity spectrum method (ATC 40). The capacity spectrum method allows for a graphical comparison between the structure capacity and the seismic demand. Pushover curve represents the lateral resisting capacity and response spectrum curve represents the seismic demand.

The capacity spectrum method, which is given in Figure 2, is started by producing force-displacement curve that consider inelastic condition. The result is then plotted to ADRS (Acceleration Displacement Response Spectrum). Demand is also converted into ADRS format so that capacity curve and demand curve are in the same format [1].

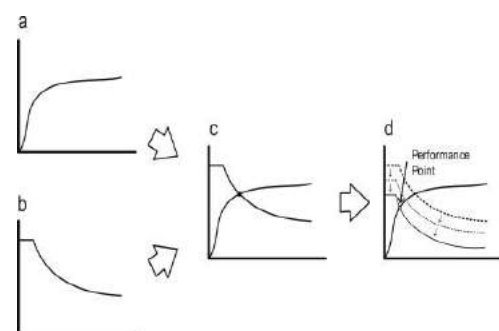

Fig. 2 Capacity Spectrum Method

- a. Pushover curve
- b. Demand spectrum
- c. ARDS format
- d. Final result

The performance point is obtained by superimposing demand spectrum on

capacity curve into spectral coordinate or ADRS format. The capacity spectrum method has been built in SAP2000 program

Performance levels of buildings are shown in table I

TABLE I  
PERFORMANCE LEVEL OF BUILDING

Level	Description
Operational	Very light damage, no permanent drift, structure retains original strength and stiffness, all systems are normal
Immediate Occupancy	Light damage, no permanent drift, structure retains original strength and stiffness, elevator can be restarted, Fire protection operable
Life Safety	Moderate damage, some permanent drift, some residual strength and stiffness left in all stories, damage to partition, building may be beyond economical repair
Collapse Prevention	Severe damage, large displacement, little residual stiffness and strength but loading bearing column and wall function, building is near collapse

### B. Nonlinear Plastic Hinge

Pushover Analysis requires the development of the force-deformation curve for the critical section of beams and column by using the guideline [3]. Such a curve is presented in Figure 3

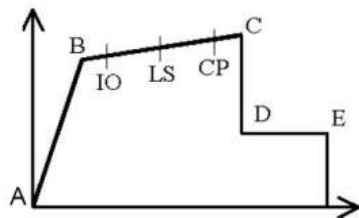

Fig. 3 Typical load-deformation relation and target performance level

Point A corresponds to the unloaded condition. Load deformation relation shall be described by linear response from A to an effective yield B. Then the stiffness reduce from point B to C. Point C has resistance equal to the nominal strength then sudden reduction in lateral load resistance to point D, the response at reduced resistance to E, final

loss of resistance thereafter. The slope of line BC, ignoring effects of gravity effects of gravity loads acting through lateral displacement, is usually taken between 0 and 10% of the initial slope. Line CD corresponds to initial failure of the member. Line DE represents the residual strength of the member.

These points are specified according to FEMA to determine hinge rotation behaviour of RC members. The points between B and C represent acceptance criteria for the hinge, which is Immediate Occupancy (IO), LS (Life Safety), and CP (Collapse Prevention).

### I. DESCRIPTIVE OF THE TEST BUILDING

The test building is a 3-story reinforced concrete building, with height story 4.0 m. The overall plan dimension is 21 x 15 square meters. Figure 3 shows the typical structural layout. Beam 1 is 700/400 and Beam 2 is 500/300 mm square for all stories. The columns are rectangular 500/300 mm. Type of soil is soft rock or site class C according to Saudi Building Code 301.

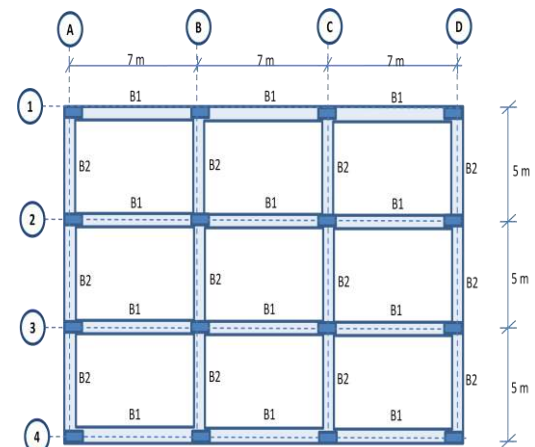

Fig. 4 Structural Layout

The structural system was designed for supporting gravity load only. Longitudinal bar in beams are bent upwards at their end to resist negative moment due to gravity load. Strong lateral load can change the moment at the end span of the beam. Therefore, the bottom

steel at end of the beam may be not adequate for lateral load. Summary of modelling assumption is presented in Table II.

TABLE II  
Modelling Assumption

Material	
Concrete	4000psi
Steel	A615Gr60
Loading	
Self-weight	Automatically by Software
Dead load	2.7 kN/m <sup>2</sup>
Live Load	2.5 kN/m <sup>2</sup>
Wind Load	Not Considered
Modelling	
Element	Linear element for beam and column Shell element for slab
P-delta effect	Not considered
Diaphragm	Shell element for slab
Support	Fixed

## II. PUSHOVER ANALYSIS

In the present paper, Pushover analysis is carried out using SAP2000 program. A three dimensional model of structure has been created as shown in Figure 5.

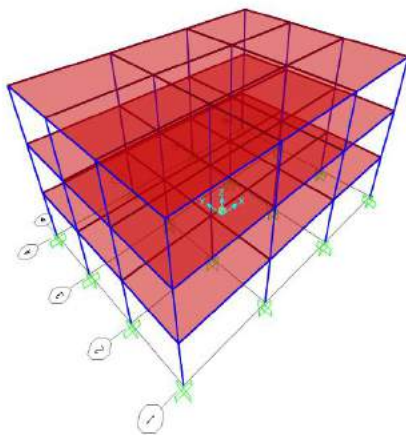

Fig. 5 Pushover Curve for X and Y Direction

Beams and columns are modelled as nonlinear frame element at the start and the end of element. The FEMA 356 rule, which is built in SAP 2000 with the IO, LS, and CP limit states for hinge rotation have been used for the acceptance criteria.

The pushover analysis is executed separately for two orthogonal directions to study the performance of the building in both directions. Gravity push, which is applied for gravity load only, Push-X is the lateral push for X direction starting at the end of gravity push, Push-Y is for Y direction starting at the end of gravity push.

The pushover analysis is achieved using a displacement control strategy, where the building is subjected the lateral load pattern until the roof displacement reach a target value. The minimum number of state used is 10 and the maximum is 100.

Pushover analysis is performed in four different regions in KSA (Makkah, Jeddah, Gizan, and Haql). Parameters Ca and Cv are taken from Saudi Building Code 301 to construct response spectrum curve as shown in figure 6.

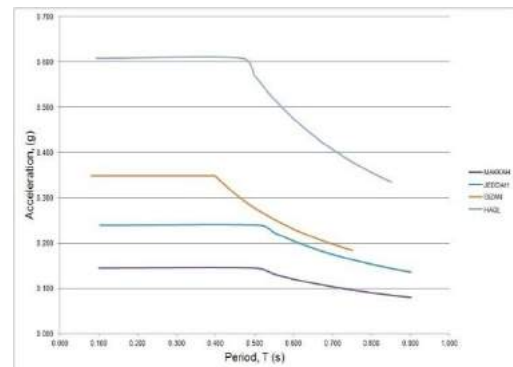

Fig. 6 Response Spectrum Curve for Each Region

## III. RESULT OF ANALYSIS

Pushover curves for the building for X and Y direction are presented in Figure 6. These curves represent the global behavior of the frame in terms of stiffness and ductility. Under incrementally increasing lateral load, the structural element may be yield sequentially. At every step, the structure experience loss in stiffness. Therefore, slope of pushover curve gradually is decreasing.



The comparison of pushover curve in X and Y direction shows that the stiffness of frame is more in X direction as compared to Y direction. This is explained that Y-direction is the critical point.

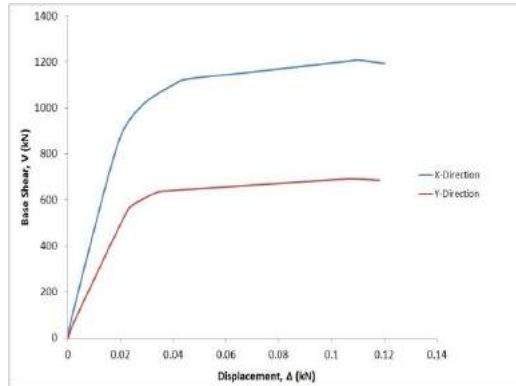

Fig. 7 Pushover Curve

The performance point has been obtained by superimposing demand spectrum on capacity curve into spectral coordinate. Figure 8 shows capacity spectrum for Gizan region in X direction. It is obvious that the demand curve tend to intersect the capacity curve at the performance point. For Gizan, It can be concluded that there are sufficient strength and displacement reserves at this performance point.

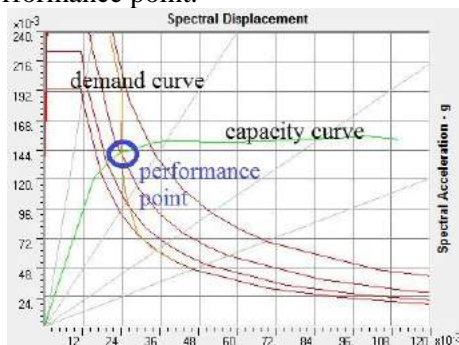

Fig. 8 Capacity Spectrum

Table III summarizes the performance point of the structure for each region.

TABLE III  
PERFORMANCE POINT FOR EACH REGION

	X-Direction			Y-Direction		
	V	d	step	V	d	step
Mekkah	675.10	0.015	2	518.84	0.021	2
Jeddah	966.48	0.026	3	633.63	0.034	5
Gizan	1014.27	0.029	4	641.26	0.039	6
Haql	1155.06	0.069	7	691.31	0.110	9

At every deformation step of pushover analysis determine plastic rotation hinge location in the elements and which hinges reach the FEMA limit state, which are IO, LS, and CP using colours for identification.

Plastic hinges formation have been obtained at different displacement levels or performance points. The hinging patterns for each region are plotted in figure 7.

*Makkah*

The element response is still not dangerous at this performance point. Yield occurs in some elements but none of them exceeds IO (Immediate Occupancy) level. The outer columns still behave in elastic range.

*Jeddah*

Most of elements are in yield condition. The damage of the building is still limited both in X and Y direction since yielding occurs at event B (yielding) to IO (Immediate Occupancy).

*Gizan*

Although the element response is generally adequate at this performance point, the response is more severe in Y-direction. The yielding at the lower column occurs at event IO (Immediate Occupancy) to LS (Life Safety).

*Haql*

For X direction, the building is still adequate due to yielding occurs at even B to IO. However, the building is not adequate for Y direction due to the lower columns yield exceed C (Collapse) condition.

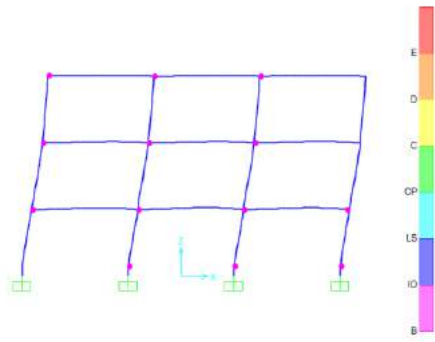

Fig. 9a Deformed Shape of the Frame-2 for Makkah (X-Dir)

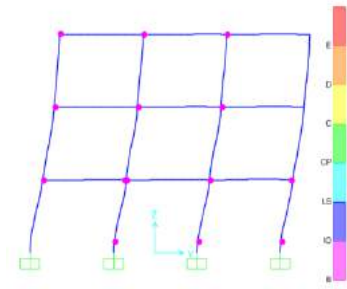

Fig. 13e Deformed Shape of the Frame-2 for Makkah (Y-Dir)

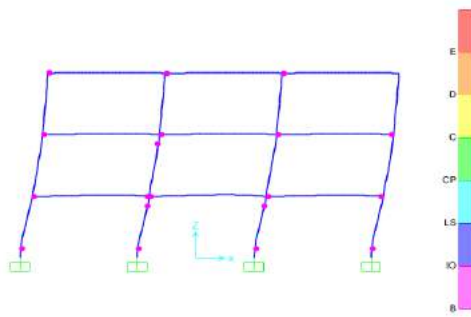

Fig. 10b Deformed Shape of the Frame-2 for Jeddah (X-Dir)

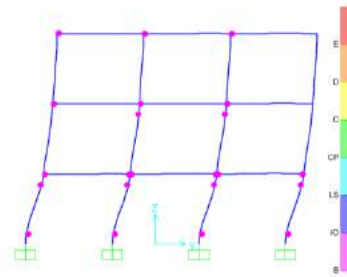

Fig. 14f Deformed Shape of the Frame-2 for Jeddah (Y-Dir)

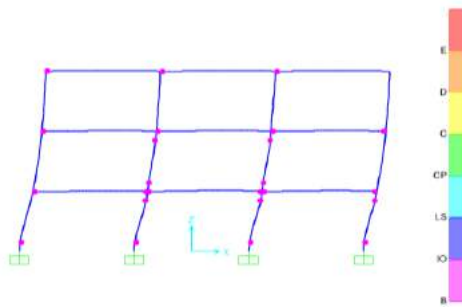

Fig. 11c Deformed Shape of the Frame-2 for Gizan (X-Dir)

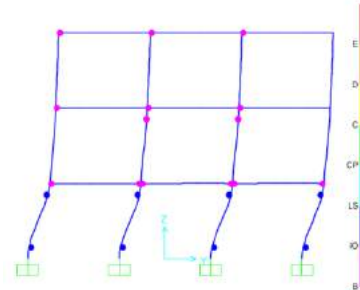

Fig. 15g Deformed Shape of the Frame-2 for Gizan (Y-Dir)

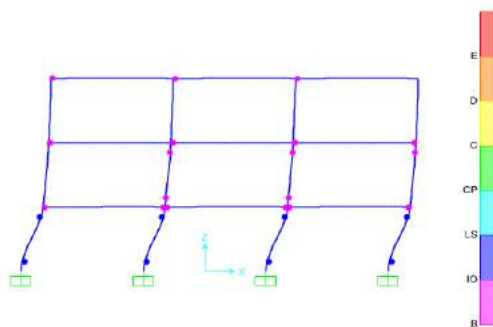

Fig. 12d Deformed Shape of the Frame-2 for Haql (X-Dir)

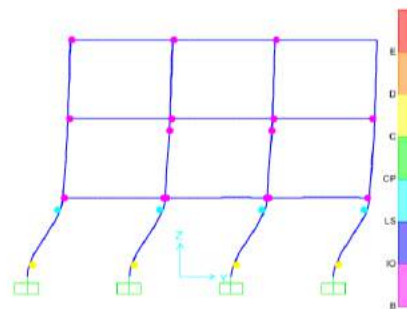

Fig. 16h Deformed Shape of the Frame-2  
for Haql (Y-Dir)

#### IV. CONCLUSION

The test building is investigated using pushover analysis. These are conclusion obtained from this analysis:

1. Pushover analysis is a simple way to investigate nonlinear behavior of the building. The result obtained gave an understanding into nonlinear behavior, which is real behavior of structure.
2. Pushover analysis is approximation method and based on static loading. It may not accurately represent dynamic phenomena.
3. The performance level of structure is indicated by intersection of demand and capacity curves and the hinges developed in the beams and the columns.
4. The results show the building that was designed only for gravity load is found inadequate for Haql region. However, the building still can be considered for Makkah, Jeddah and Gizan.
5. Pushover analysis can identify weak elements by predicting failure mechanism and account for redistribution of forces during progressive yielding. It may help engineers make action for rehabilitation work.

#### REFERENCES

1. Applied Technology Council, *Seismic Evaluation and Retrofit of Reinforced Concrete Buildings*, Report ATC 40 /, 1996.
2. The Saudi Code National Building Committee, *The Saudi Building Code 301 Structural – Loading and Forces*, 2007.
3. American Society of Civil Engineers, *FEMA-356: Prestandard and Commentary for The Seismic Rehabilitation of Buildings*, 2000.
4. Attar, M. S, "Evaluation of the Seismic Performance of A Typical School Building" Master Thesis, College of Engineering, KAAU, 2003.
5. Abd-alla, Mohamed N, "Application of Recent Techniques of Pushover for Evaluating Seismic Performance of Multistory Building" Faculty of Engineering, Cairo University, 2007
6. Giannopoulos, P.I "Seismic Assessment of RC Building according to FEMA 356 and Eurocode 8" 16th Conference on Concrete, TEE, ETEK, 21-23/10/2009
7. Vijayakumar, A and Babu, D.L.V. "Pushover Analysis of Existing Reinforced Concrete Framed Structures" European Journal of Scientific Research, ISSN 1450-216X Vol.71 No.2 (2012), pp. 195-202
8. Chopra, A.K and Goel, R.K "A Modal Pushover Analysis Procedure to Estimate Seismic Demands for Unsymmetric-plan Buildings" Earthquake Engng Struct. Dyn. 2004; 33 :903–927 (DOI: 10.1002/eqe.380)
9. Elnashai, A.S. "Advanced inelastic static (pushover) analysis for earthquake applications" Structural Engineering and Mechanics, Vol 12, No. 1, 2001
10. Poluraju, P and Rao, N. "Pushover Analysis of reinforced concrete frame structure using SAP 2000" International Journal of Earth Science and Engineering ISSN 0974-5904, Volume 04, No 06 SPL, October 2011, pp. 684-690
11. Fajfar, P. "Structural Analysis in Earthquake Engineering – Breakthrough of Simplified Nonlinear Methods" 12<sup>th</sup> European Conference on Earthquake Engineering, Paper References 843

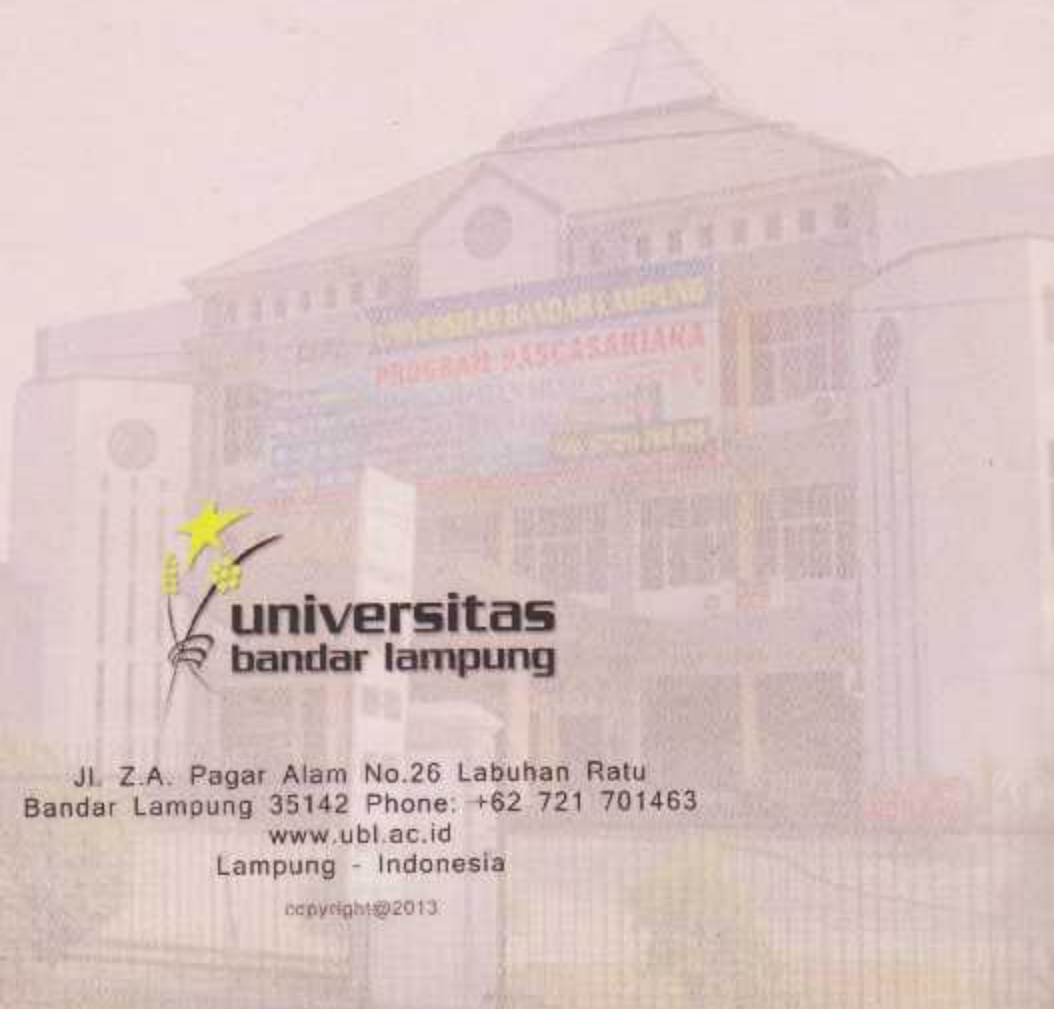

**universitas  
bandar lampung**

Jl. Z.A. Pagar Alam No.26 Labuhan Ratu  
Bandar Lampung 35142 Phone: +62 721 701463  
[www.ubl.ac.id](http://www.ubl.ac.id)  
Lampung - Indonesia

copyright © 2013